

# the Vent-Free Series

- ⊙ Tested and listed to be placed directly on a combustible floor.
- ⊙ Does not require a chimney.
- ⊙ Full masonry unit with large standard opening requiring minimal floor space.
- ⊙ Can be fitted with a gas appliance B-vent (6 inch minimum) for improved indoor air quality.
- ⊙ Suitable for use with any AGA listed “vent-free” gas log appliance (ANSI Z223.1).

## SPECIFICATIONS

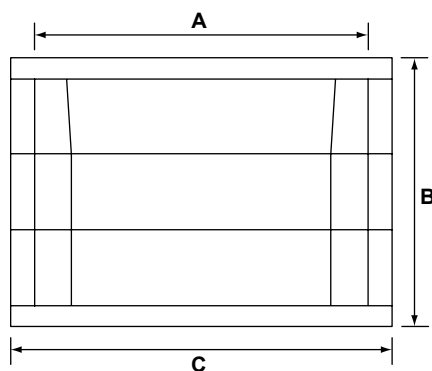

### 36 inch Vent-Free

A	B	C	D	E	F
37"	37 $\frac{5}{8}$ "	43"	31 $\frac{1}{8}$ "	25 $\frac{1}{4}$ "	37"

**weight:** 900 lbs.

**minimum framing:** 44"W x 39"H x 26 $\frac{3}{4}$ "D

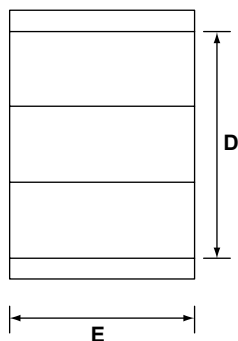

### 42 inch Vent-Free

A	B	C	D	E	F
43"	37 $\frac{5}{8}$ "	49"	31 $\frac{1}{8}$ "	25 $\frac{1}{4}$ "	43"

**weight:** 900 lbs.

**minimum framing:** 50"W x 39"H x 26 $\frac{3}{4}$ "D

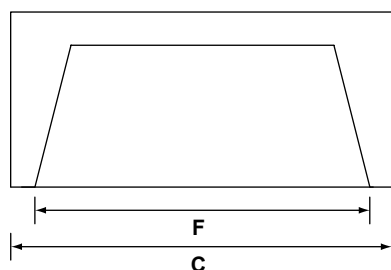

### 46 inch Vent-Free

A	B	C	D	E	F
47"	37 $\frac{5}{8}$ "	53"	31 $\frac{1}{8}$ "	25 $\frac{1}{4}$ "	47"

**weight:** 900 lbs.

**minimum framing:** 54"W x 39"H x 26 $\frac{3}{4}$ "D



The Vent-Free Series may not be approved for use in bedrooms and bathrooms. Please check with local gas code enforcement. Only “vent-free” gas log appliance (per ANSI Z223.1) is to be used. Always check instruction manual for details or contact your local dealer prior to installation. All Vent-Free Series fireplace systems can be custom finished to suit design, homeowner or builder needs. All Isokern® fireboxes require firebrick lining. Measurements and/or specifications are subject to change without prior notification.



UL 127, ICC ER 5017

1.800.642.2920

<http://www.isokern.net>

